

SANDING

Pneumatic Belt Sander

BELTON

Ideal for sanding and grinding in narrow spaces, recessed areas and on curved surfaces

- Quick belt change
- Rear exhaust system

BELTON-10

Model **B-10CL** 

- Belt size 10 mm (W)



BELTON-20

Model **B-20CL** 

- Belt size 20 mm (W)

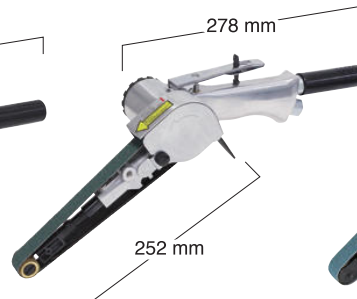

The Idle Pulley for B-20CL is supported on one side only.



BELTON-20

Model **B-20CL-A** 

- Belt size 20 mm (W)

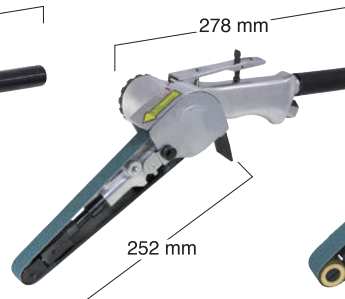

The Idle Pulley for B-20CL-A is supported on both sides.



BELTON-30

Model **B-30CL** 

- Belt size 30 mm (W)

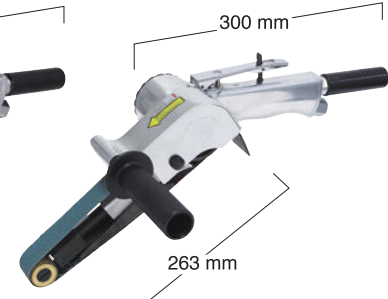

Specifications					
Model		B-10CL	B-20CL	B-20CL-A	B-30CL
Air Pressure	MPa (kgf/cm ²)		0.6 (6)		
Air Consumption (No-load)	m ³ /min	0.4	0.48		0.82
Free Speed	min ⁻¹ (rpm)	17000	18000		15000
Belt Speed	m/min	1120	2770		2310
Belt Size	mm	10 x 330	20 x 520		30 x 540
Inlet Size			Rc 1/4		
Mass (Weight)	kg	0.9	1.6	1.5	2.4
Accessories Included		<ul style="list-style-type: none">• 2 pieces of Abrasive Belt Z#60 x 10 mm (1 piece installed)• Abrasive Belt Z#80 x 10 mm• Abrasive Belt Z#100 x 10 mm• Abrasive Belt Z#120 x 10 mm• 1.5 mm Hex. Socket Screw Key• 4 mm Hex. Socket Screw Key• Bushing R 1/4 x NPT 1/4	<ul style="list-style-type: none">• 2 pieces of Abrasive Belt Z#60 x 20 mm (1 piece installed)• Abrasive Belt Z#80 x 20 mm• Abrasive Belt Z#100 x 20 mm• Abrasive Belt Z#120 x 20 mm• 2.5 mm Hex. Socket Screw Key• 4 mm Hex. Socket Screw Key• Bushing R 1/4 x NPT 1/4• Convex Shoe	<ul style="list-style-type: none">• 2 pieces of Abrasive Belt Z#60 x 30 mm (1 piece installed)• Abrasive Belt Z#80 x 30 mm• Abrasive Belt Z#100 x 30 mm• 5 mm Hex. Socket Screw Key• Handle Assy• Bushing R 1/4 x NPT 1/4	

Easy belt change

Abrasive belt can be changed easily. *Rotate and open the cover when changing.

Self-locking

Push the idle pulley into self-lock position to loosen the belt.

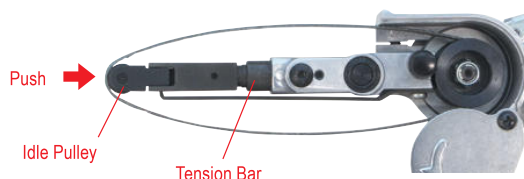

For all models

Unlock

Press the push button to pull back the tension bar.

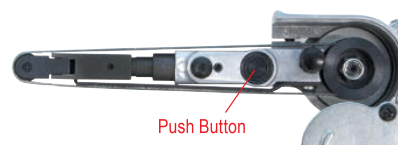

10/20 Type

Press the shoe in the direction of the arrow.

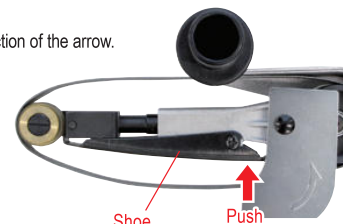

30 Type

SANDING

Adjustable angle for efficient operation

Guard angle can be changed freely in accordance with the working position and shape of the workpiece.

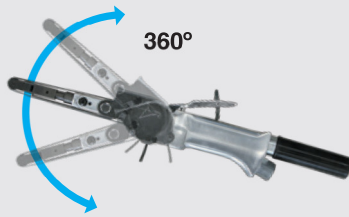

Belt Speed Adjustment

Belt speed can be easily adjusted by turning the adjust valve with a screwdriver.

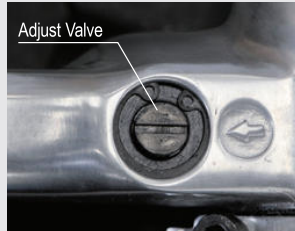

Curved surface grinding

Curved surface grinding is possible by using the Offset Bracket (Optional).

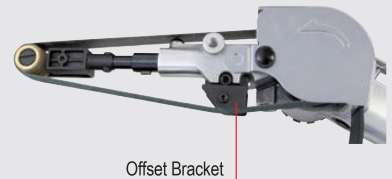



Abrasive Belt for BELTON-10

Belt Size : 6 mm x 330 mm (W x L)

Grit	PN	
	Zirconia (Z)	Alumina (AA)
#40	-	-
#60	TB00241	-
#80	TB00242	-
#100	TB00243	-
#120	TB00244	-
#180	TB00245	-
#240	TB00246	-
#400	-	TA9A237
Sales Unit	 50 pcs./set When using the belt, optional Bracket 6 Ass'y and Shoe 6 are required. (Ref. No. 5, 6)	

Abrasive Belt for BELTON-10

Belt Size : 10 mm x 330 mm (W x L)

Grit	PN		
	Zirconia (Z)	Alumina (AA)	Ceramic (CE)
#40	-	-	TB08368
#60	TA9A064	-	TB08369
#80	TB00076	-	TB08370
#100	TB00077	-	TB08371
#120	TB00247	-	TB08372
#180	TB00248	-	-
#240	TB00249	-	-
#400	-	TA9A244	-
Sales Unit	 50 pcs./set		 50 pcs./set



Abrasive Belt for BELTON-20

Belt Size : 20 mm x 520 mm (W x L)

Grit	PN		
	Zirconia (Z)	Alumina (AA)	Ceramic (CE)
#40	TA99605	-	TB08373
#60	TA99606	-	TB08374
#80	TA99607	-	TB08375
#100	TA99608	-	TB08376
#120	TA99609	-	TB08377
#180	TB00250	-	-
#240	TB00251	-	-
#320	-	TA9A253	-
#400	-	TA9A254	-
Sales Unit	 20 pcs./set	 20 pcs./set	 20 pcs./set

Abrasive Belt for BELTON-30

Belt Size : 30 mm x 540 mm (W x L)

Grit	PN		
	Zirconia (Z)	Alumina (AA)	Ceramic (CE)
#40	TB00252	-	TB08378
#60	TB00253	-	TB08379
#80	TB00254	-	TB08380
#100	TB00255	-	TB08381
#120	TB00256	-	TB08382
#180	TB00257	-	-
#240	TB00258	-	-
#320	-	TA9A263	-
#400	-	TA9A264	-
Sales Unit	 20 pcs./set		 20 pcs./set

Optional Parts

Ref. No.	PN	Description	Sales Unit	Applicable Model		
				B-10CL	B-20CL B-20CL-A	B-30CL
1	TB09997	Offset Bracket 10 Ass'y	1 set	●		
2	TB10192	Offset Bracket 20 Ass'y	1 set		●	
3	TB08150	Offset Bracket 30 Ass'y	1 set			●
4	TB09938	Finger Pad Ass'y	1 set		●	
5	TB09996	Bracket 6 Ass'y	1 set	●		
6	TP14770	Shoe 6	1 piece	●		
7	TB10191	Convex Shoe	1 piece		●	



* for Abrasive belt width 6 mm

